

Activity 4: 3D Canada Physical Regions



Explore bit.ly/ArcCanadaAtlas!

1. **Open Map** > *Canada: Physical*
2. **3D** > Turn your map into a globe.
3. **Map Layers** > See more information about the landform in the popups.
4. **Measure** > **Profile** > Draw a profile line that connects from the Pacific to Atlantic Oceans. Click once to start, twice to finish drawing the line.



These are the map tools in the Atlas 3D tool.

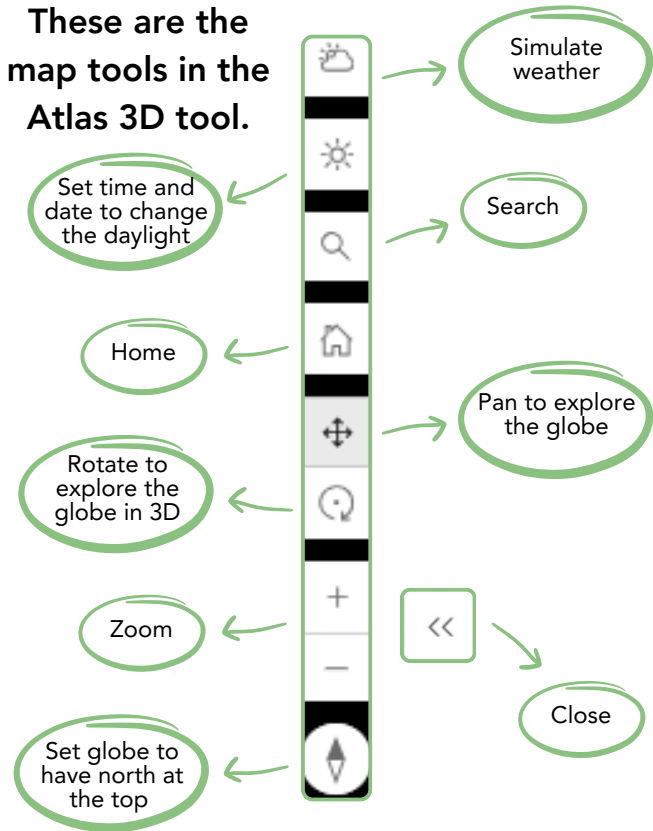

5. Bring the **cursor** over the profile to explore the connection between elevation and landform regions. After you explore, close the profile.



6. **Search** > Canmore, AB

7. **Map Layer** > turn off *Canada's Physiographic Regions*.

8. **Rotate** > the globe to explore the mountains and the contour lines

9. **Basemap** > Choose *Imagery Hybrid*. Explore the mountains again.

10. Add some **Weather** in the mountains.

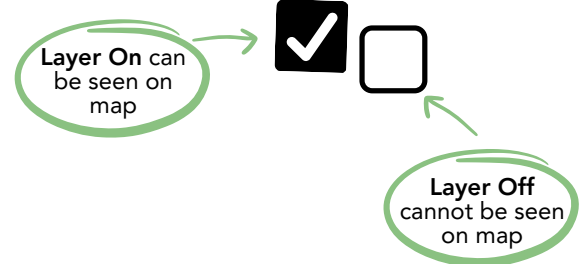
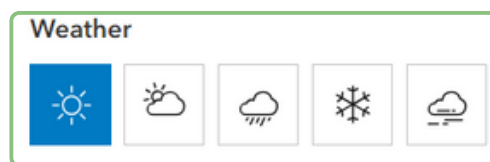
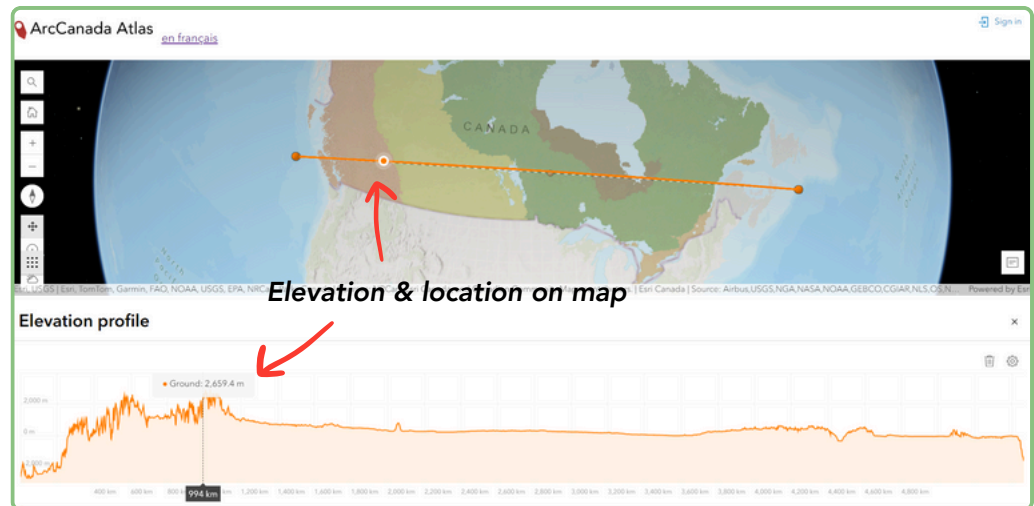

11. Explore the other physical regions in Canada.

